

FR1500S

Flush-Mounted RS-485 Fingerprint Reader



Single Gang



Waterproof IP65



Features

- Single gang Standard junction box installation.
- RS-485 Communication Interface.
- Stainless Steel Front casing.
- Supports IP65 rate.
- Flush-Mounted Design for neat installation.
- Z-ID Fingerprint Sensor.
- Fingerprint Protective Cover.

Specifications

Additional Info

Working Temperature: -10 °C ~ 45 °C
 Working Humidity: 20 ~ 95%
 Dimensions(LxWxH): 121.3 × 77.3 × 38 mm
 Algorithm: ZKFinger v10.0

Power Supply

Operating Voltage 12V DC
 Stand-by Mode Power Consumption: 12V*60mA=0.72W
 Peak Current of Fingerprint scanning: 140mA

Hardware

1.0 GHz CPU
 Z-ID Sensor
 Buzzer Prompt
 Three-color Indicator Light

Compatibility

inBio/inBioPro Controllers
 Standalone Fingerprint Devices

Standard Features

125KHz RFID Card

Optional Features

125KHz HID Prox Card
 13.56MHz IC Card(S50 / S70)
 13.56MHz HID Iclass Card

Communication

RS485

Configuration

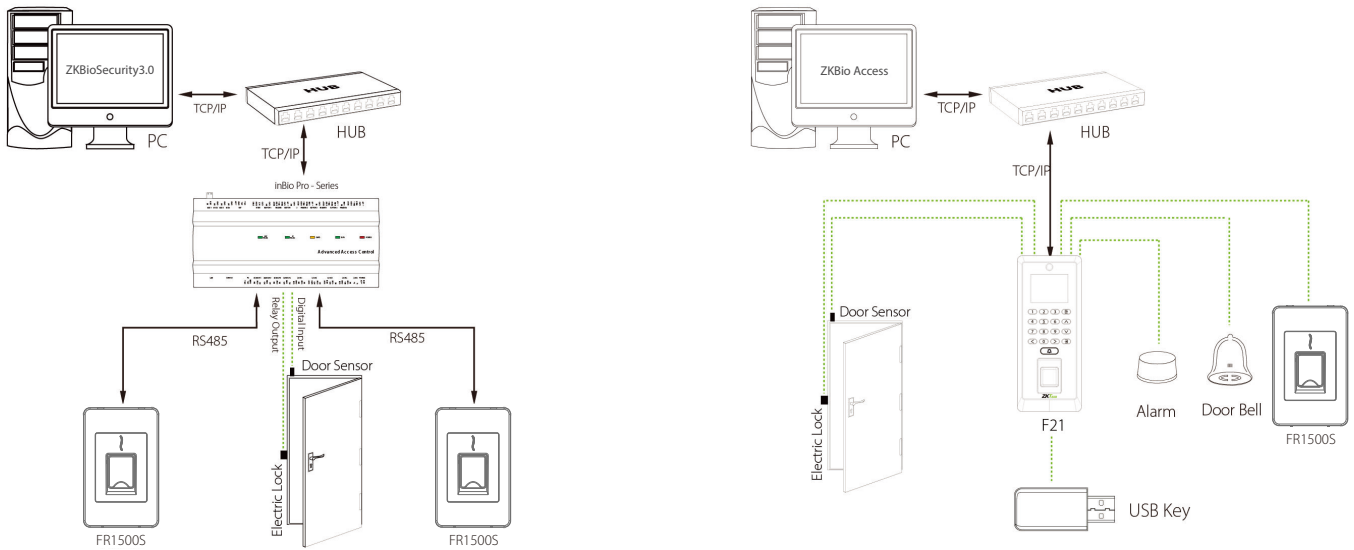

Dimensions (mm)

